

# THE GREVILLE

HOUSE TYPE: G2 Detached  
TOTAL FLOOR AREA: 1095 ft<sup>2</sup> approx.



Computer visual

Note - Solar panel positions vary on site depending on site number and location.

Beverley Garden  
*Village*

BANGOR ROAD · NEWTOWNARDS

eHome

# THE GREVILLE

HOUSE TYPE: G2 Detached  
TOTAL FLOOR AREA: 1095 ft<sup>2</sup> approx.



Telephone 028 9181 4144  
[www.reedsrains.co.uk](http://www.reedsrains.co.uk)



**Lagan eHomes** have been designed to be more sustainable by retaining heat and saving on energy bills.

The energy efficiency of these homes is achieved by using thermally efficient insulation, highly thermal doors and windows and the latest in heating technology.



Computer visual.



[www.laganhomes.com](http://www.laganhomes.com)

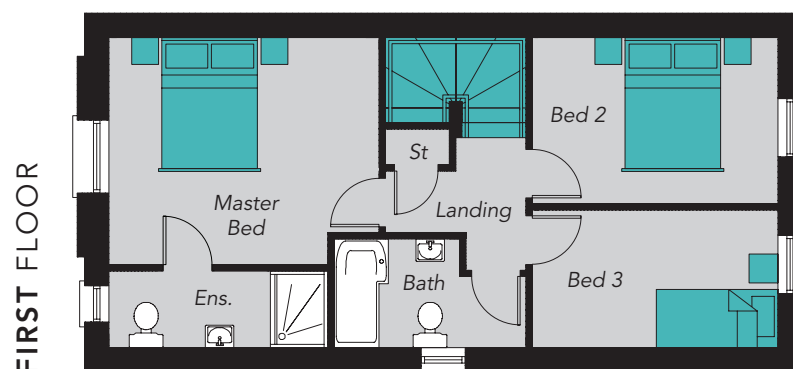

## GROUND FLOOR

Entrance Hall	
Lounge <i>max</i>	15'8" x 13'8"
Kitchen / Dining	15'8" x 12'5"
WC	

## FIRST FLOOR

Master Bedroom	11'5" x 13'8"
Ensuite	
Bedroom 2	12'5" x 8'4"
Bedroom 3	12'5" x 6'10"
Bathroom	

These particulars do not constitute any part of an offer or contract. None of the statements contained in these particulars are to be relied on as statements or representations of fact and intending purchasers must satisfy themselves by inspection or otherwise as to the correctness of each of the statements contained in these particulars. All measurements of area are quoted as Net Sales Area which is calculated in accordance with the RICS Code of Measuring Practice (6th Edition) APP 21. Configurations of kitchens, bathrooms and wardrobes may be subject to alteration from those illustrated without prior notification. Purchasers should satisfy themselves as to the current specification at the time of booking. The Vendor does not make or give, and neither the Selling Agent, nor any person in their employment, has any authority to make or give any representation or warranty whatever in relation to any property. Computer visuals are for illustration only. Plans are not to scale and all dimensions shown are approximate.